

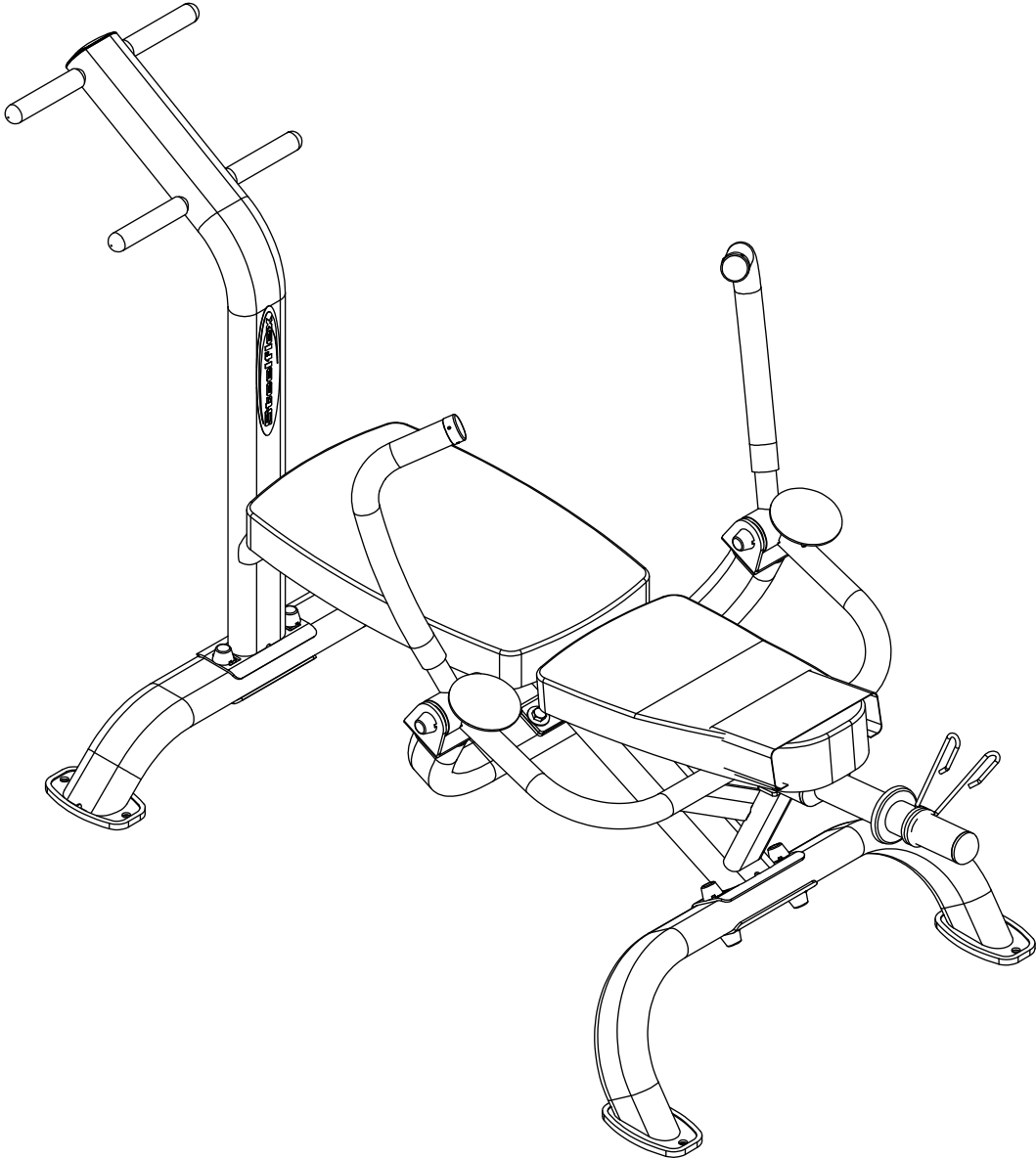

NAB.5



Assembly & Instructions
OWNER'S & MANUAL

NAB.5 HARDWARE
(shown in actual size)

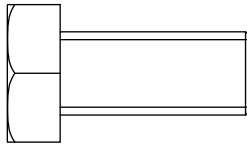
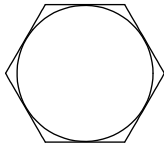

A1.M12X25L Hex Head Screw Qty.2

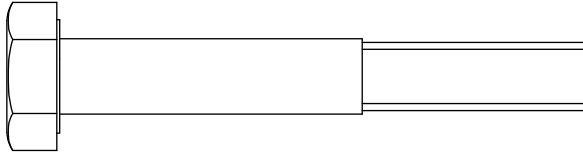
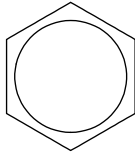

A2.M10X70L Hex Head Screw Qty.4

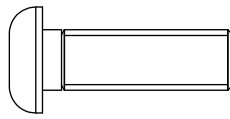
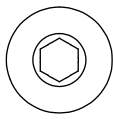

A3.M8X25L Allen Screw(Full Thread) Qty.8

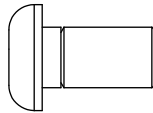
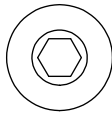

A4.M8X15L Round Head Screw Qty.4

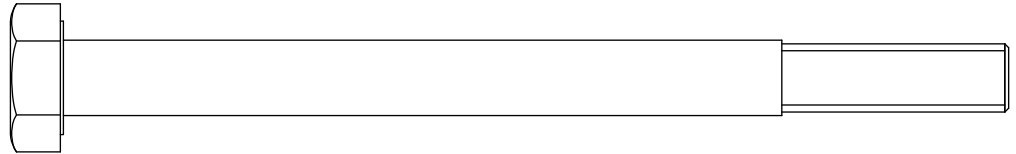
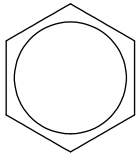

A6.M10X125L Hex Head Screw Qty.2



A7.M5X5L Socket Head Cap Screw (Pre-installed) Qty.4

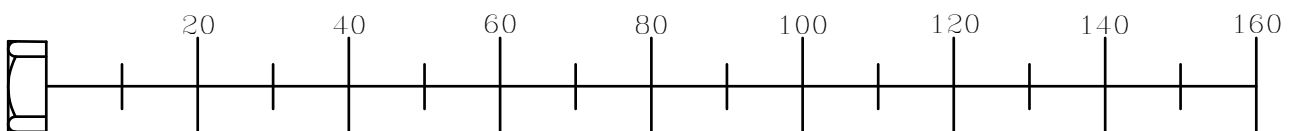

NAB.5 HARDWARE
(shown in actual size)

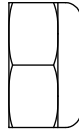
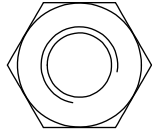

B1.M10 Nylon Lock Nut Qty.6

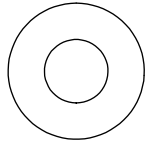

C1.M8 Washer (Ø18) Qty.8

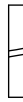
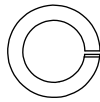

C2.M8 Spring Washer Qty.12

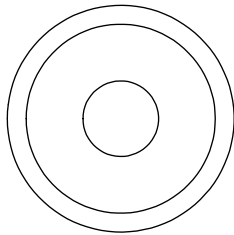

C3.M10 Plate Washer Qty.12

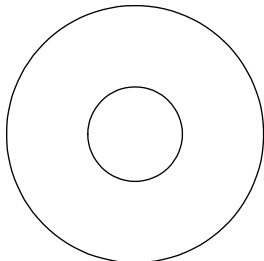

C4.M12 Washer Qty.2

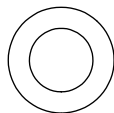

C5.M8 (Ø14) Washer Qty.4

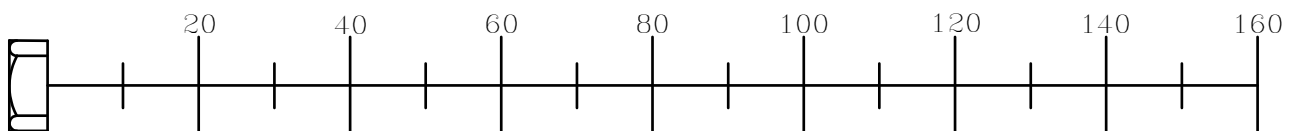

NAB.5 HARDWARE
(shown in actual size)

A[1PCS]

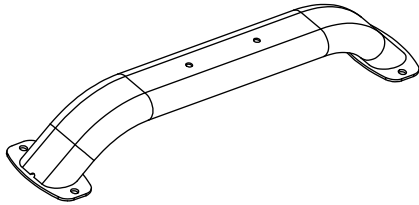

B[1PCS]

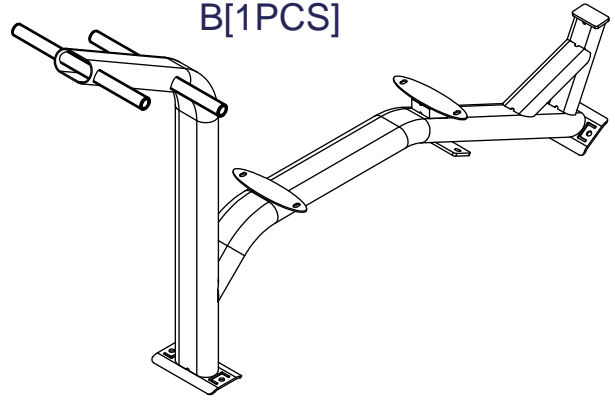

C[1PCS]

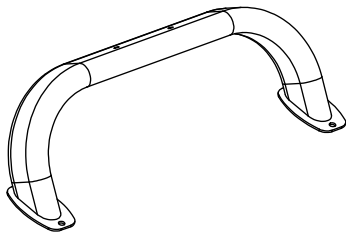

D[1PCS]

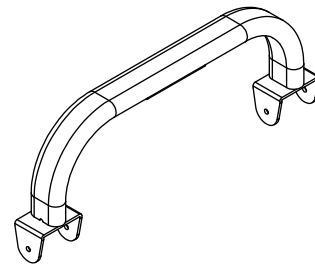

E[1PCS]

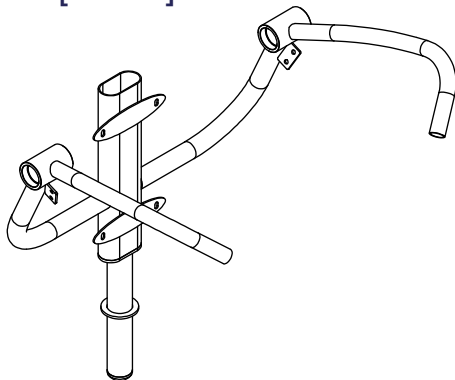

G[2PCS]

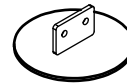

**I[2PCS]
(8323-188)**

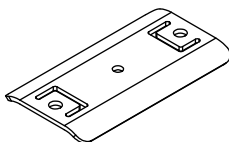

**K[1PCS]
(9121-101)**

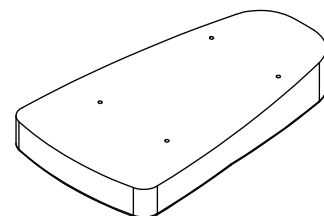

**J[1PCS]
(9121-100)**

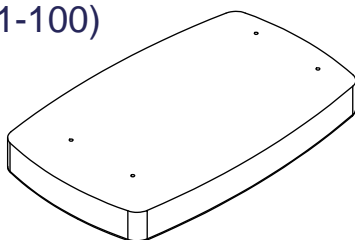

NAB.5 HARDWARE
(shown in actual size)

D1.M10 Bolt Cap.....	12PCS
D2.50X100 End Cap(9211-193).....	2PCS
D4.Rubber Pad(9310-076).....	4PCS
D5.38X4TX55L Rubber Slice(9310-028).....	1PCS
D6.Ø90x50x10t Rubber Circle(9310-016).....	1PCS
D7.Pinch Cock(OC06).....	1PCS

D1



D2

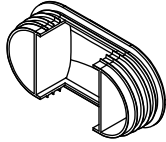

D4

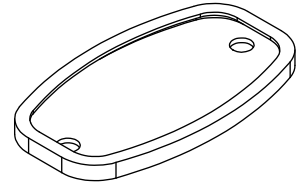

D5

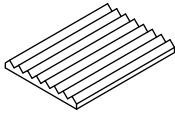

D6

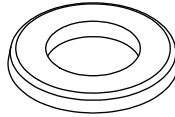

D7



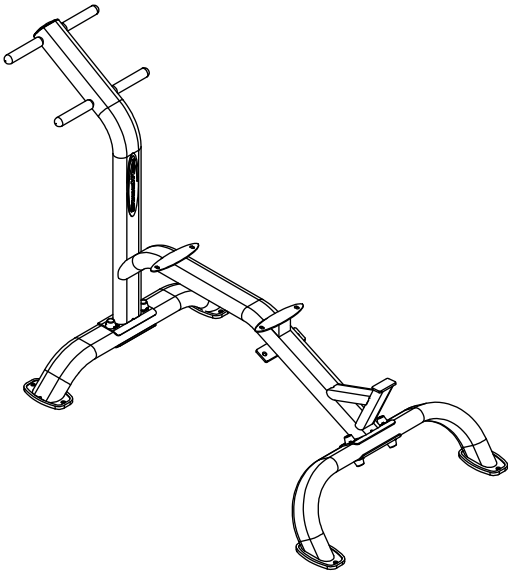

Above shows STEP assembled and completed

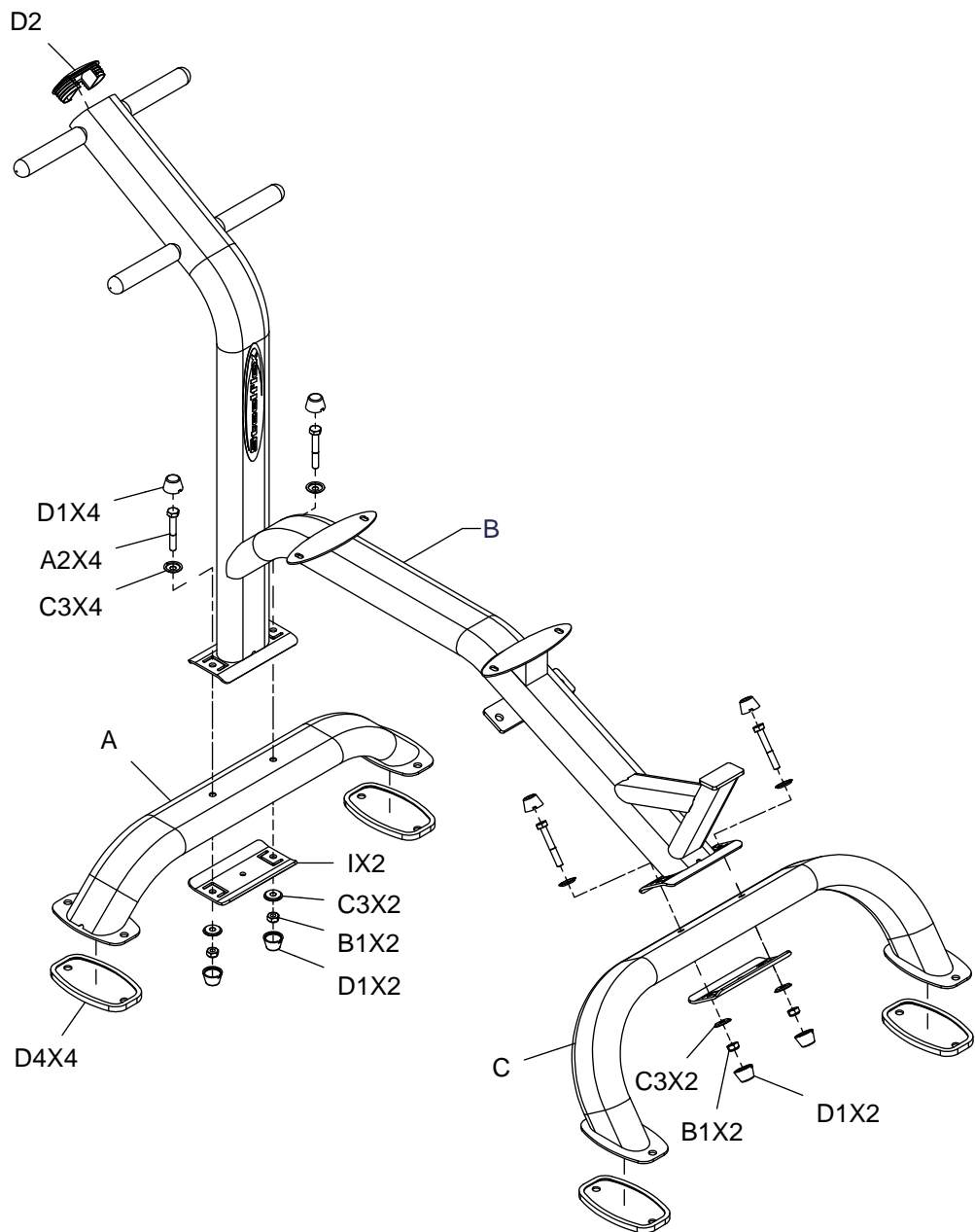

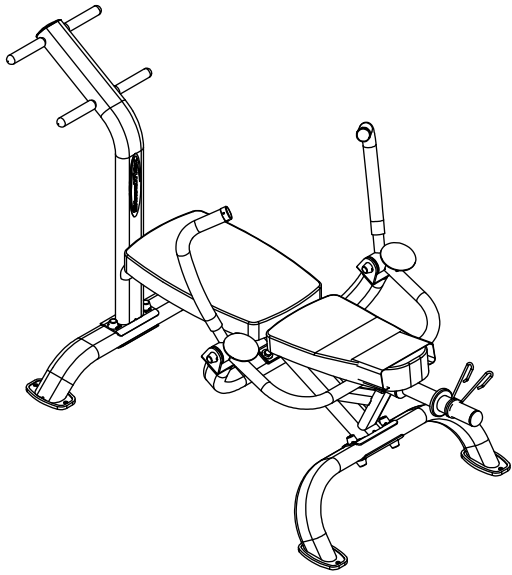

Above shows STEP assembled and completed

