

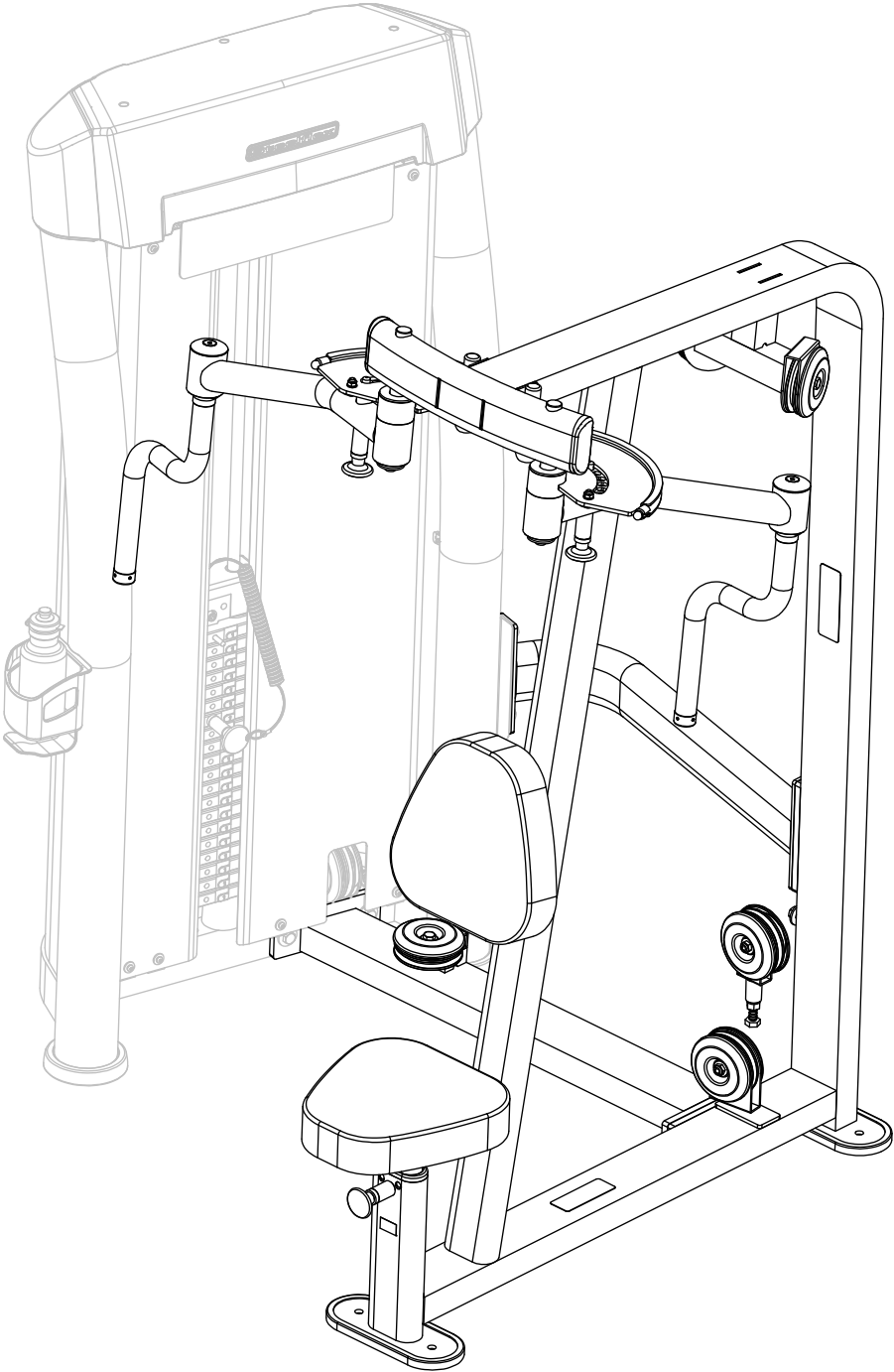

*JGPD700*



Assembly & Instructions  
**OWNER'S & MANUAL**

**JGPD700 HARDWARE**  
(shown in actual size)

A1.M8X25L Hex Head Bolt Qty.8

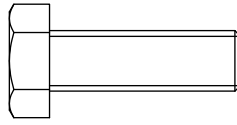
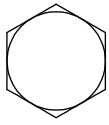

A2.M10X25L Taper Flat Head Socket Screw Qty.6

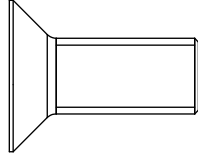
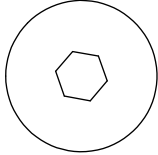

A3.M10X45L Hex Head Bolt Qty.3

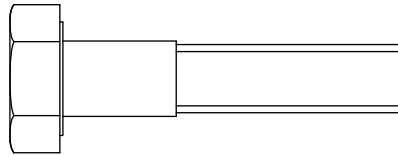
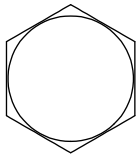

A4.M10X50L Hex Head Bolt Qty.2

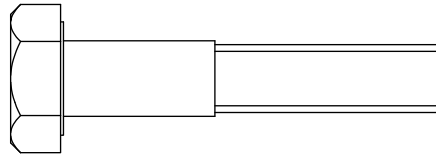
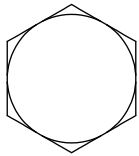

A5.M12X20L Round head socket CAP screw Qty.2

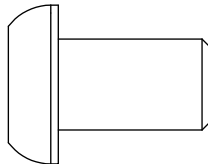
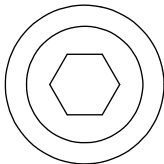

A6.M12X25L Hex Head Bolt Qty.4

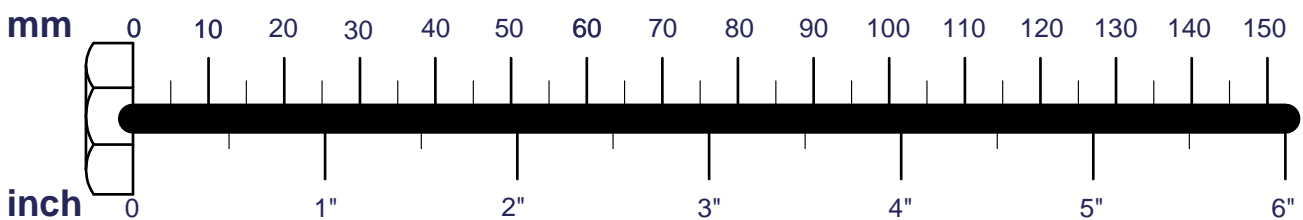
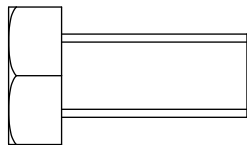
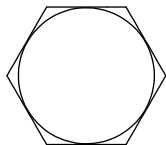

**JGPD700 HARDWARE**  
(shown in actual size)

A7.M8X25L Cup Head Inner Hexagon Screw Qty.4(Pre-installed)

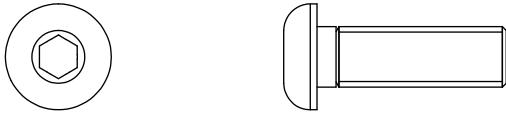

A8.M5X5L Countersunk Head Inner Hexagon Screw Qty.8(Pre-installed)



C1.M8 Spring Washer Qty.8



C2.M8 Washer (Ø22) Qty.8

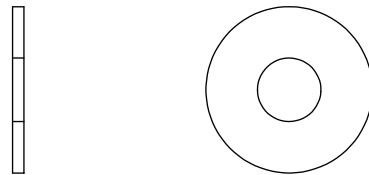

C3.1/2" Spring Washer Qty.2

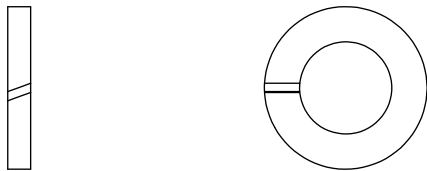

C4.M10 Spring Washer Qty.3

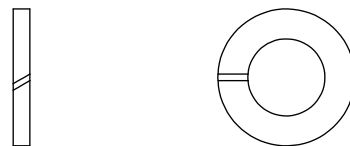

C5.M12 Spring Washer Qty.6

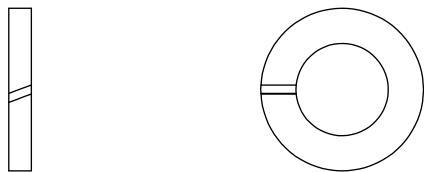

C6.M10 Washer (Ø28) Qty.7

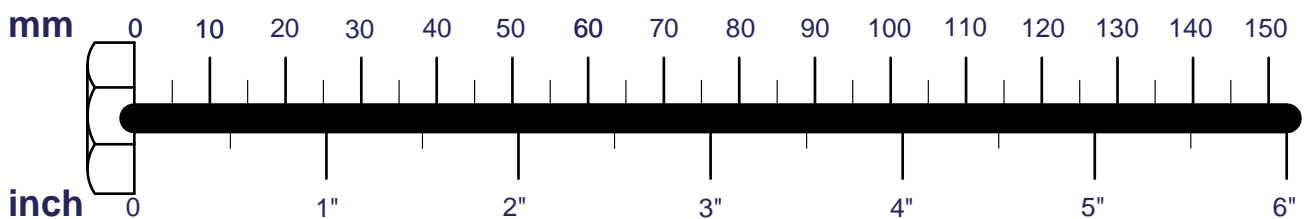
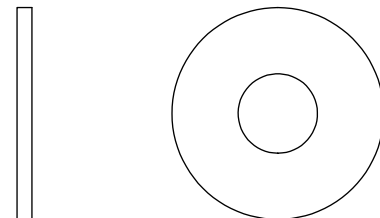

**JGPD700 HARDWARE**  
(shown in actual size)

C7.M12 Washer (Ø34) Qty.4

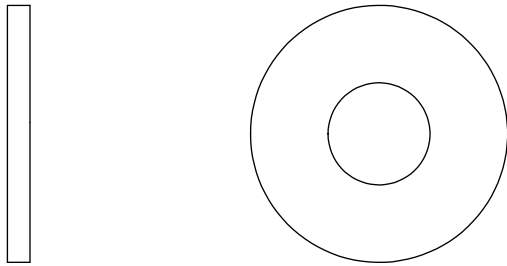

C10. Washer (Ø16) Qty.8(Pre-installed)

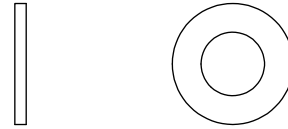

C8.M12 Washer (Ø44) Qty.2

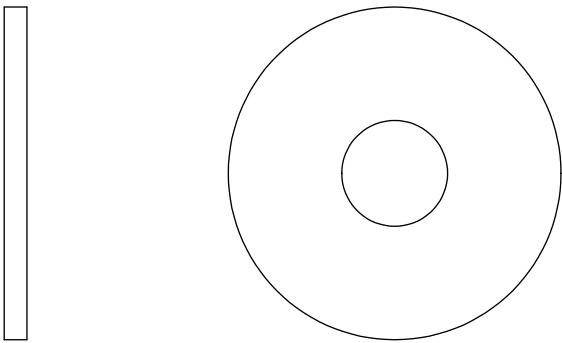

C9. Washer (Ø26.7XØ58X3.2T) Qty.2

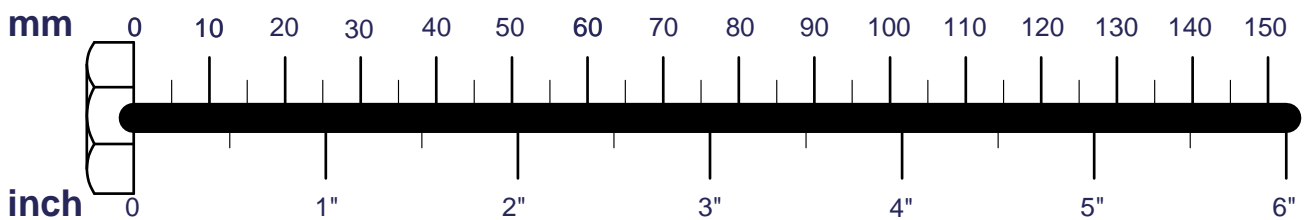
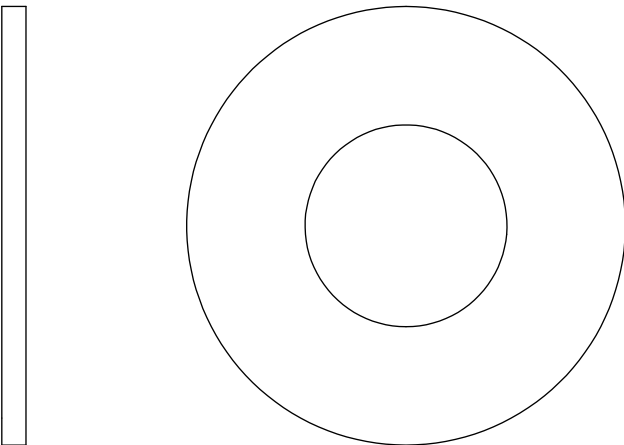

**JGPD700 HARDWARE**  
(shown in actual size)

B1. 1/2 Nut 13unc Qty.2

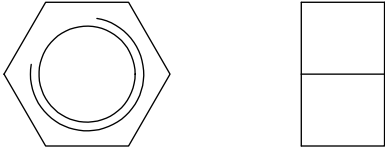

B2. M10 Nylon Lock Nut Qty.2

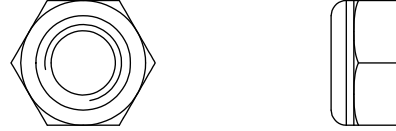

B3. M8 Nut Qty.4(Pre-installed)



JGPD700 HARDWARE  
(shown in actual size)

O[1PCS]

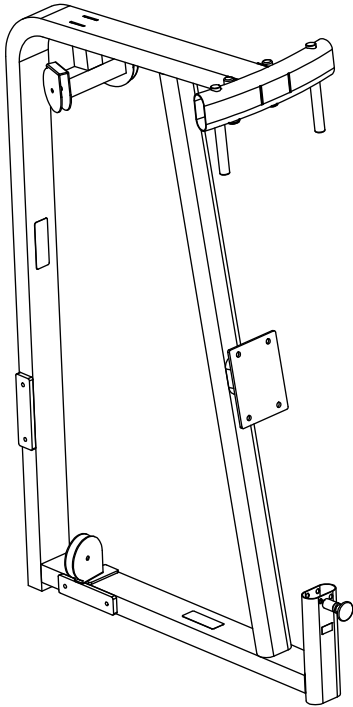

P[1PCS]

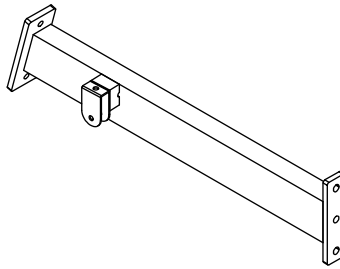

Q[1PCS]

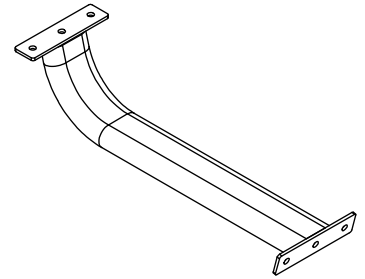

R[1PCS]

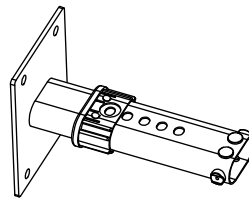

S[2PCS]  
(9121-093)

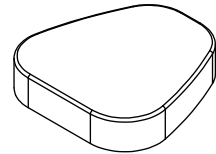

T[2SET]

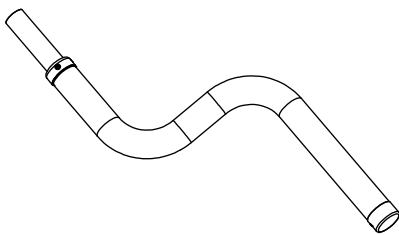

Z[1PCS]

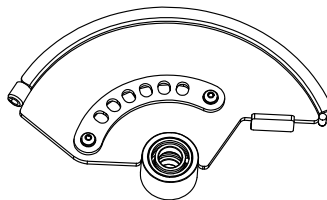

V[1PCS]  
(6640-019)

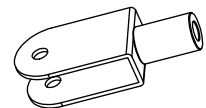

X[2SET]

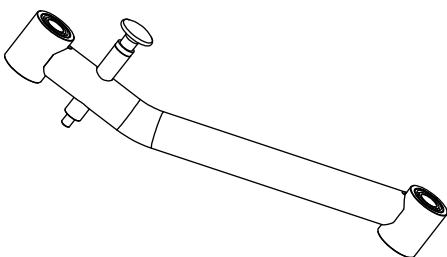

Y[1PCS]

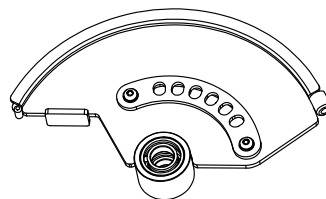

H[2PCS]  
(8313-188)

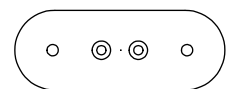

# JGPD700 HARDWARE

(shown in actual size)

D1.End Cap (8130-248).....	2PCS
D2.The Elliptical Pipe Plug(9211-193).....	2PCS
D3.Rubber Pad(9212-019)(Pre-installed).....	2PCS
D4.Copper Washer(8520-008).....	10PCS
D5.Rubber Blanket(9310-075).....	2PCS
D6.Belt Pulley(9213-002C).....	5PCS
D7.The Round Side Kover(9211-173).....	7PCS
D8.3705mm Steel Cable.....	1PCS
D9.3625mm Steel Cable.....	1PCS
D10.End Closure(8130-253)(Pre-installed).....	2PCS
D11.Chrome Collar(8890-061)(Pre-installed).....	2PCS
D12.Iron Cover(8510-018)(Pre-installed).....	12PCS
D13. Regulator Pole(8250-095)(Pre-installed).....	2PCS
D14.Adjust Team(8250-066)(Pre-installed).....	1PCS
D15.The Elliptical Pipe Plug(9211-207)(Pre-installed).....	1PCS
D16.Snap Fastener(9211-118)(Pre-installed).....	2PCS
D17.Snap Fastener(9211-036)(Pre-installed).....	4PCS
D18.Fixing Flat(8343-394)(Pre-installed).....	2PCS

D1



D2

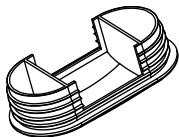

D3

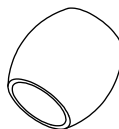

D4



D5

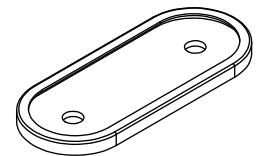

D6

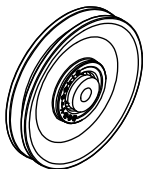

D7



D8

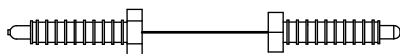

D9

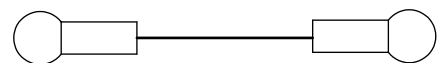

D10



D11



D12



D13

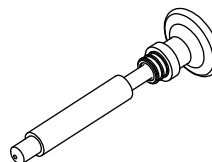

D14

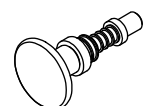

D15



D16



D17



D18

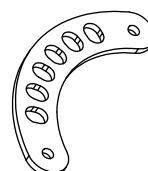

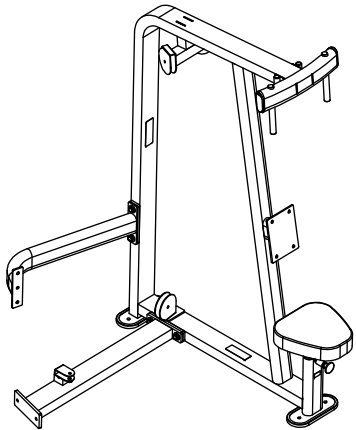

Above shows STEP 1 assembled and completed

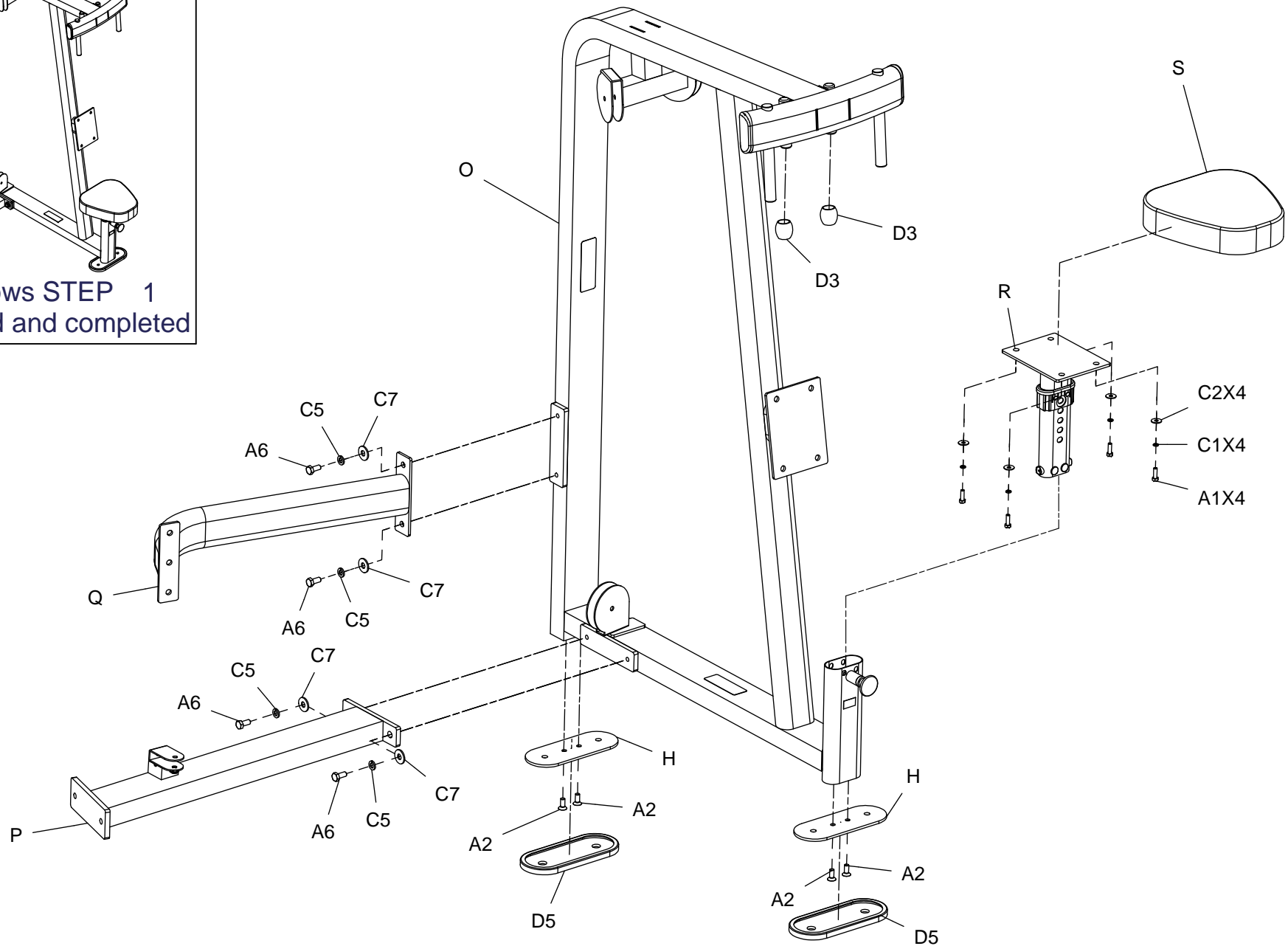

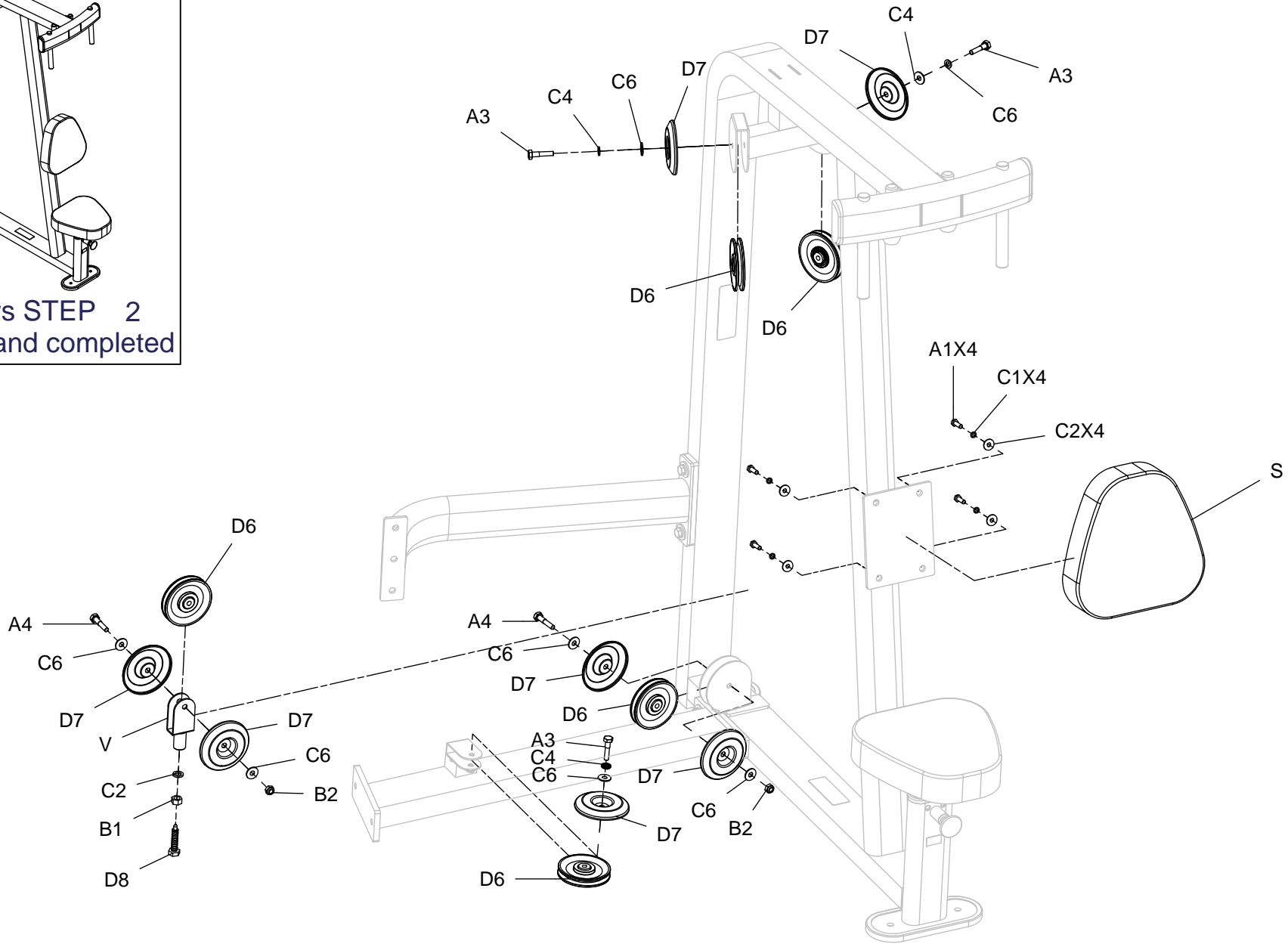
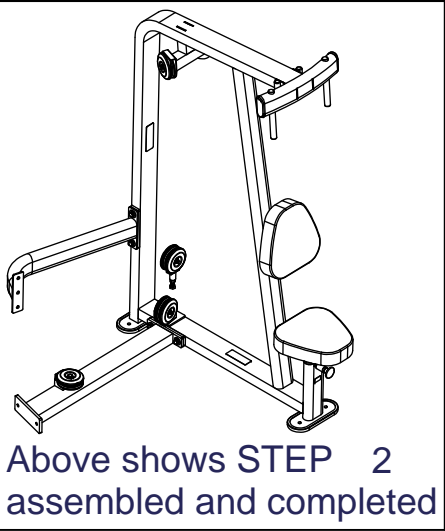





# JGPD700 Exploded View

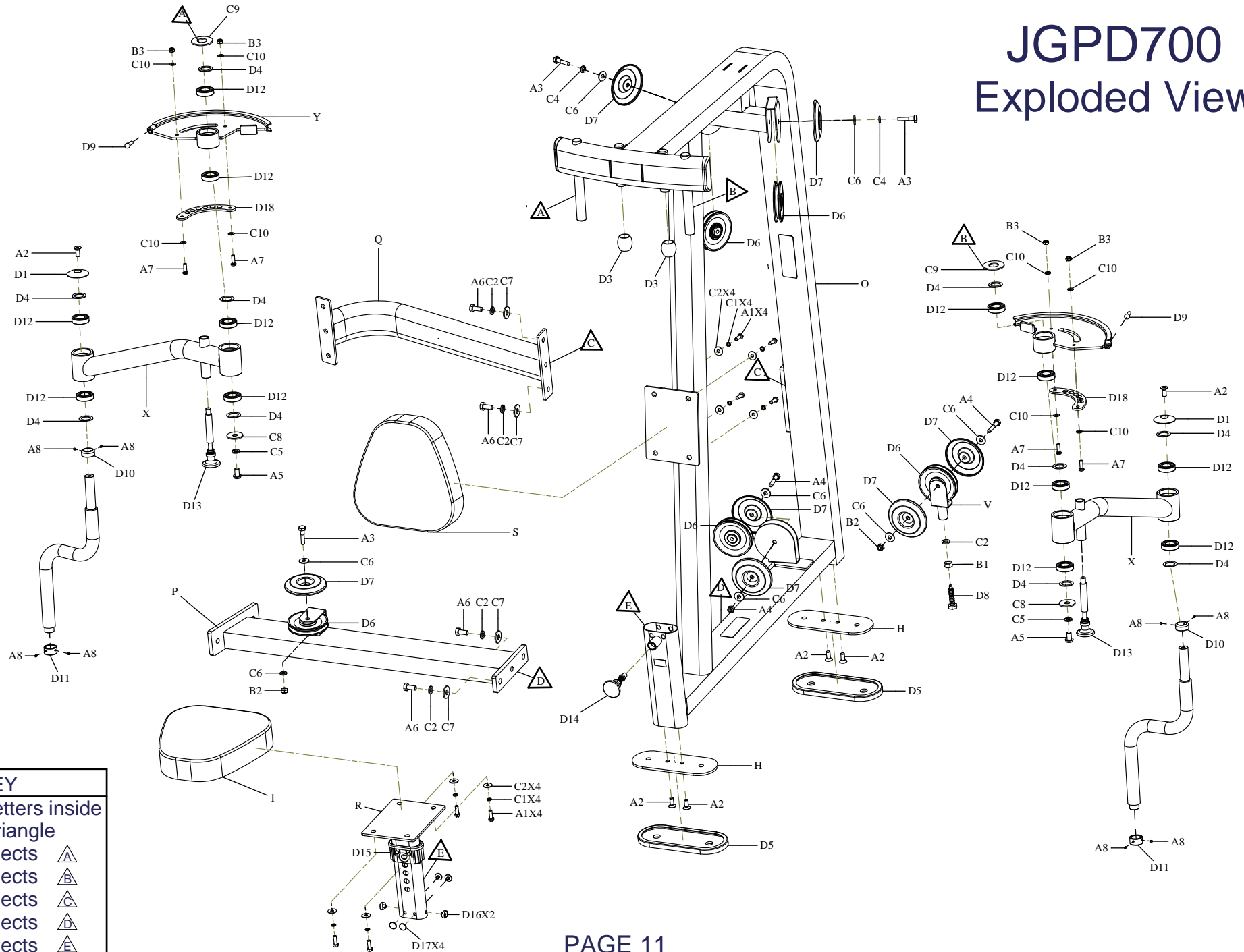

KEY	
Match the letters inside each triangle	
△ A	connects △ A
△ B	connects △ B
△ C	connects △ C
△ D	connects △ D
△ E	connects △ E