

* PLBP Maintenance



* Customers can put some grease on pivot points (red circle place), with brass or gunmetal bushings.



WD-40多种规格



* Let's maintain your machine!

PLBP.7 PARTS

A [1PCS]

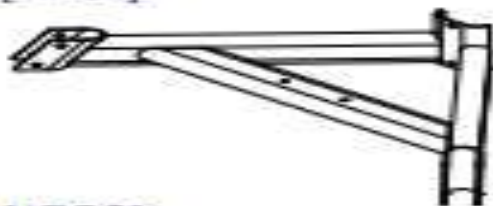

B [1PCS]



C [1PCS]

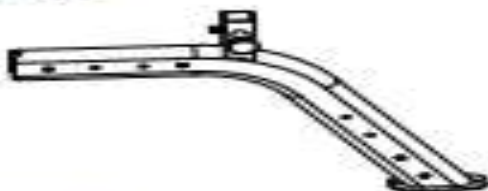

D [1PCS]

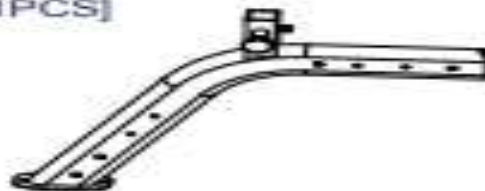

E [1PCS]

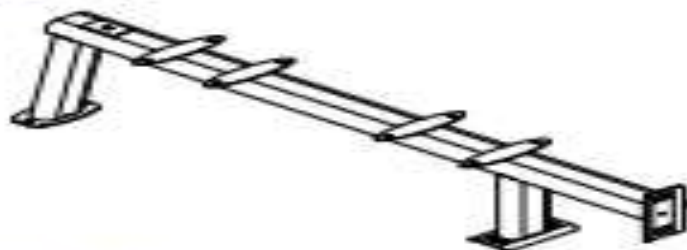

F [2PCS]
6730003



I [1PCS]



H [1PCS]



J [4PCS]
6730001



K [3PCS]
8323234



L [1PCS]
9111071



M [1PCS]
9121075

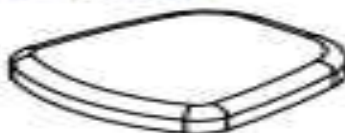

N [1PCS]
9131025



O [1PCS]
9119010



PLBP.7 PARTS

D1. End Closure (8130-248)	[2PCS]
D2. Compression Spring (8840-059)	[2PCS]
D3. Ø50 End Cap (9211-020)	[2PCS]
D4. Nylon Bushing (9211-030)	[2PCS]
D6. 40x80 End Cap (9211-192)	[2PCS]
D7. 50x100 END CAP (9211-193)	[1PCS]
D8. Rubber Dount (9310-016)	[6PCS]
D9. Rubber Insert (9310-076)	[4PCS]
D10. Block Rubber (9310-077)	[2PCS]
D11. Pinch Cock (OC-06)	[2PCS]
D14. Chrome Collar (8890-048) pre-installed	[2PCS]
D15. Bearing (8510-037) pre-installed	[4PCS]
D16. Impregnated With Handle (9162-149) pre-installed	[2PCS]
D17. End Closure (8130-287)pre-installed	[2PCS]
D18. End Cover(9211-169)per-installed	[2PCS]

D1



D2



D3



D4

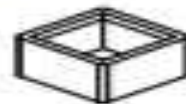

D6



D7



D8



D9



D10



D11



D14



D15



D16



D17



D18



Above shows STEP 1
assembled and completed

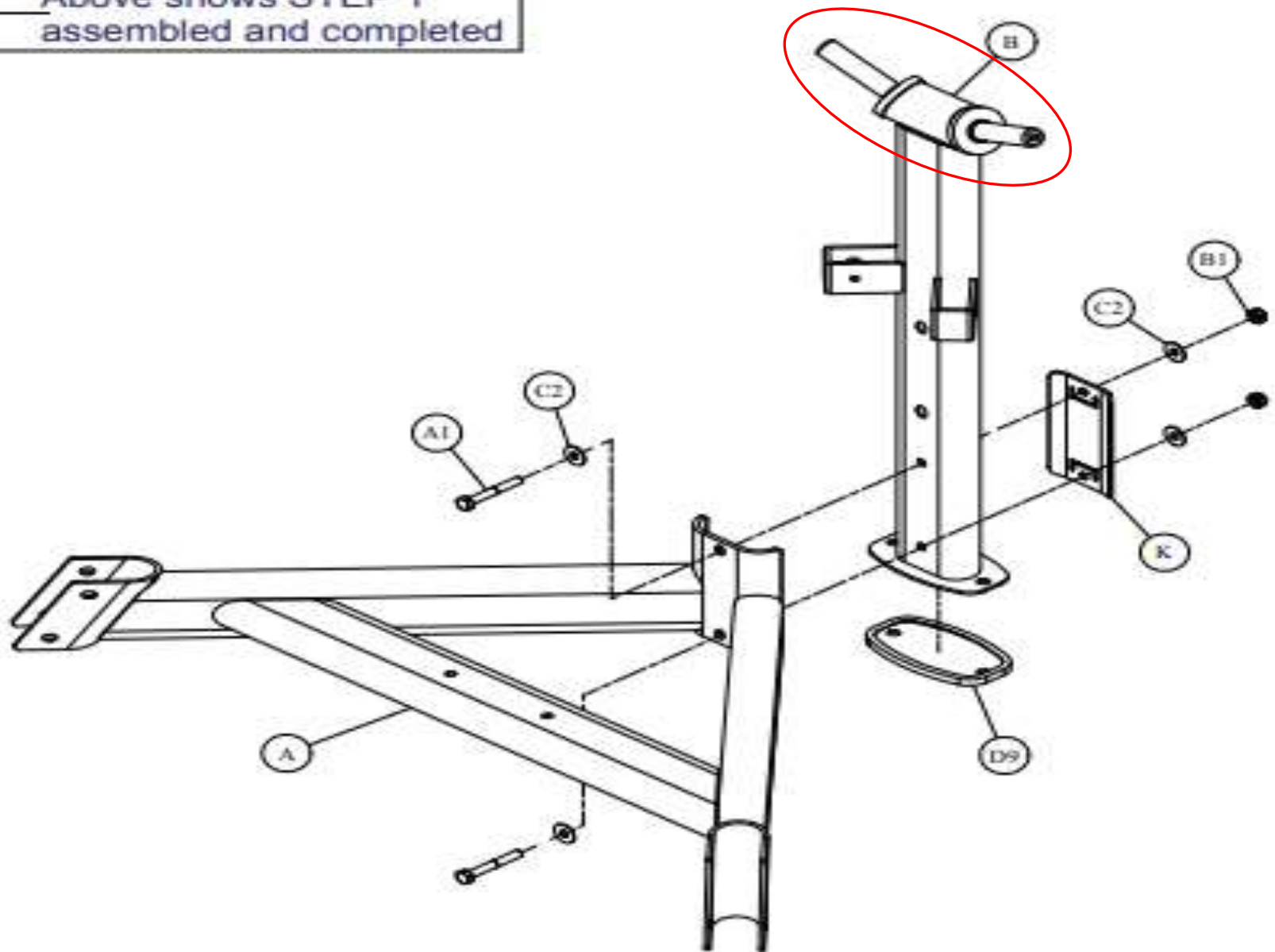

Above shows STEP 2
assembled and completed

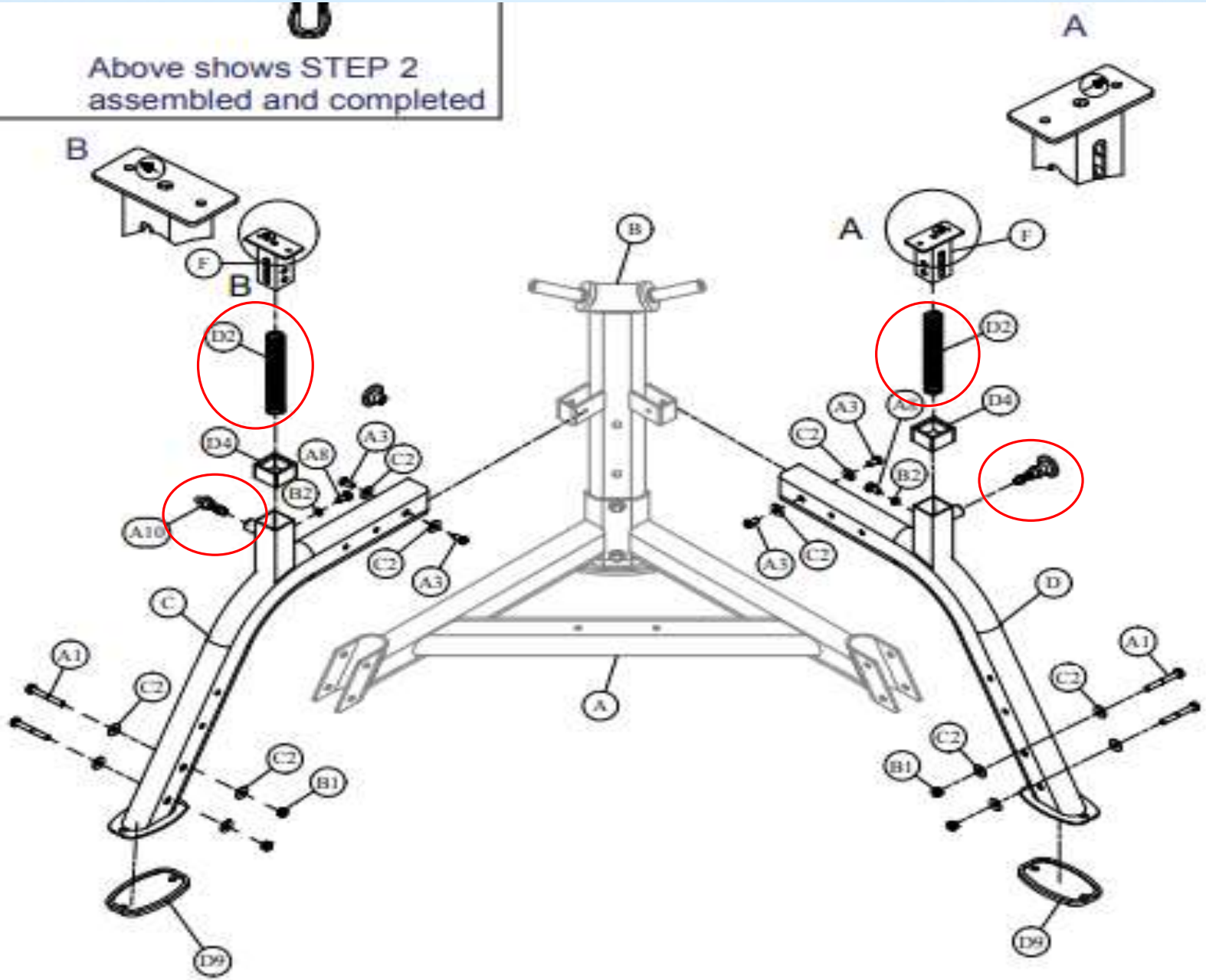

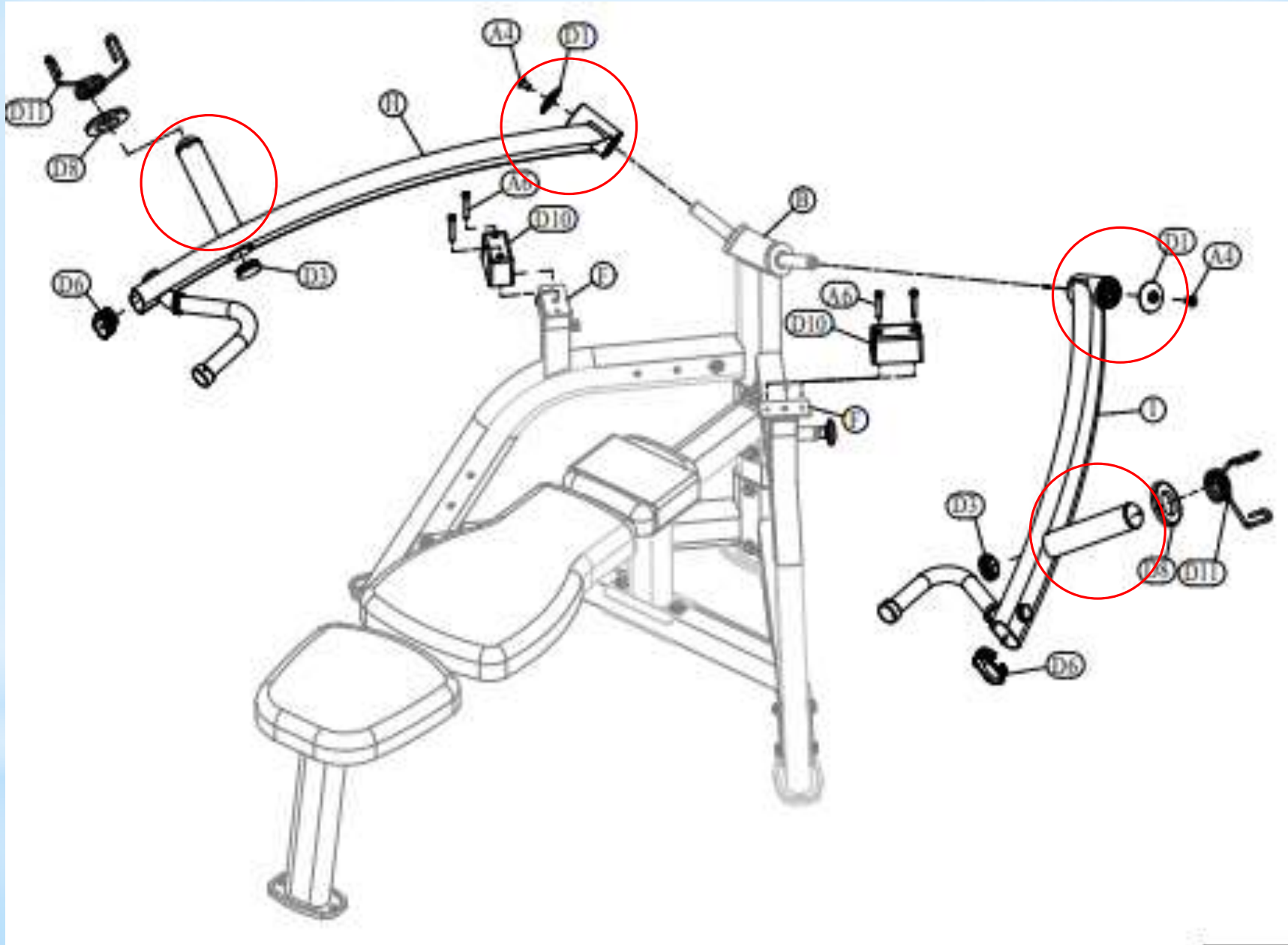

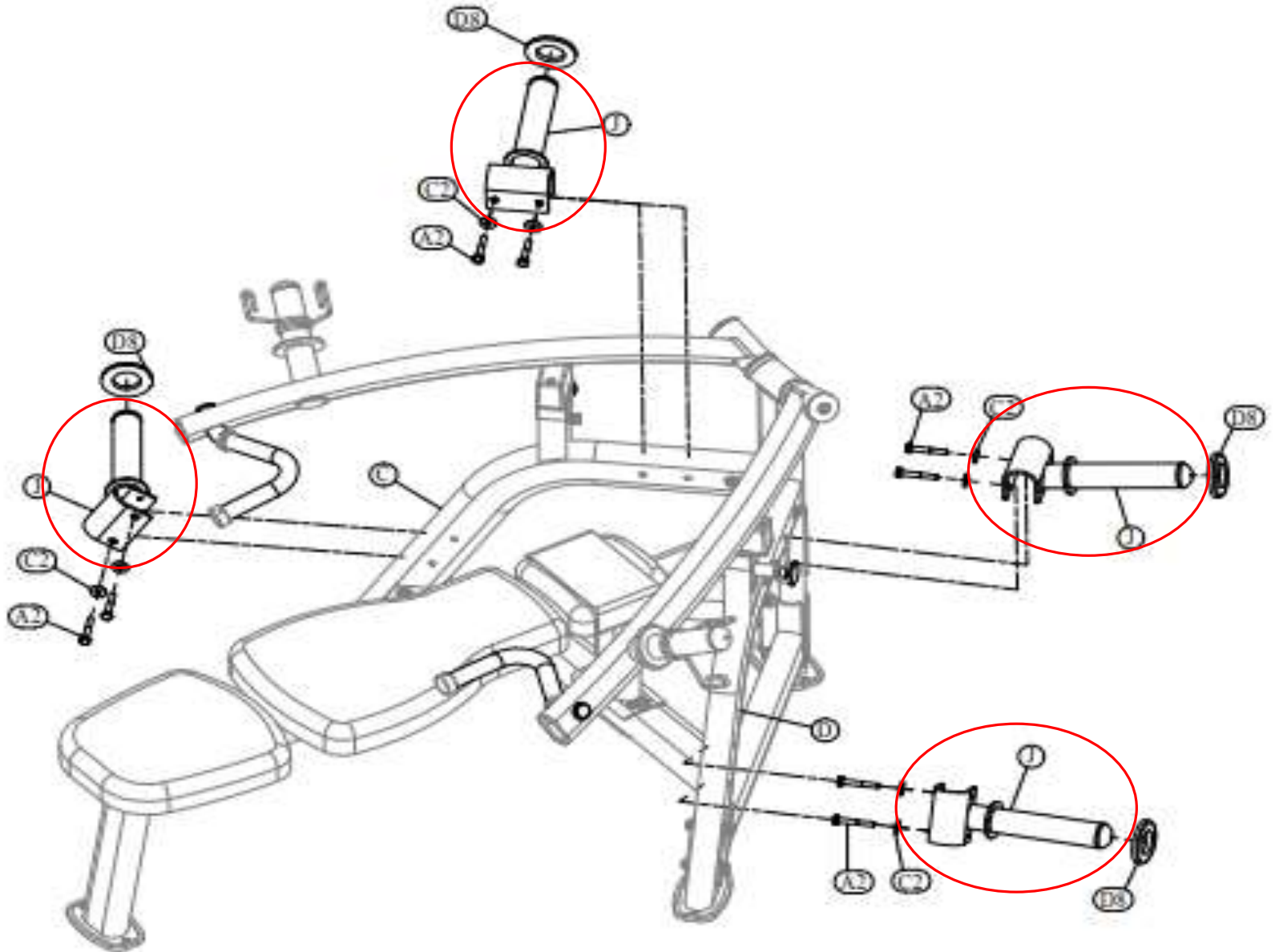

PLBP.7

Exploded View

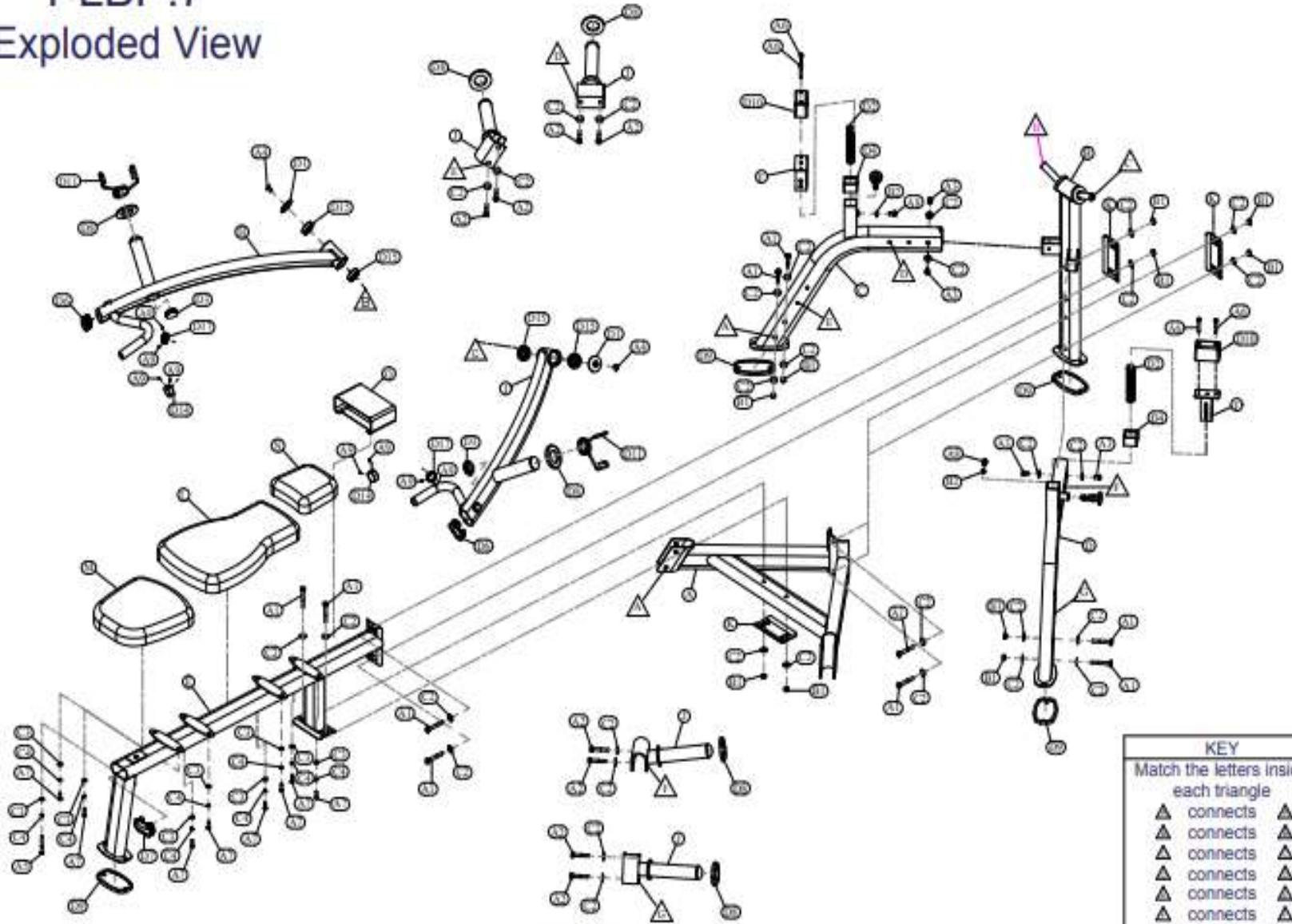

KEY	
△	connects △
△	connects △
△	connects △
△	connects △
△	connects △
△	connects △
△	connects △

*Well done!

